

Central

Map to Gratiot Lake Conservancy

Noblet Field Station

5173 Noblet Lane

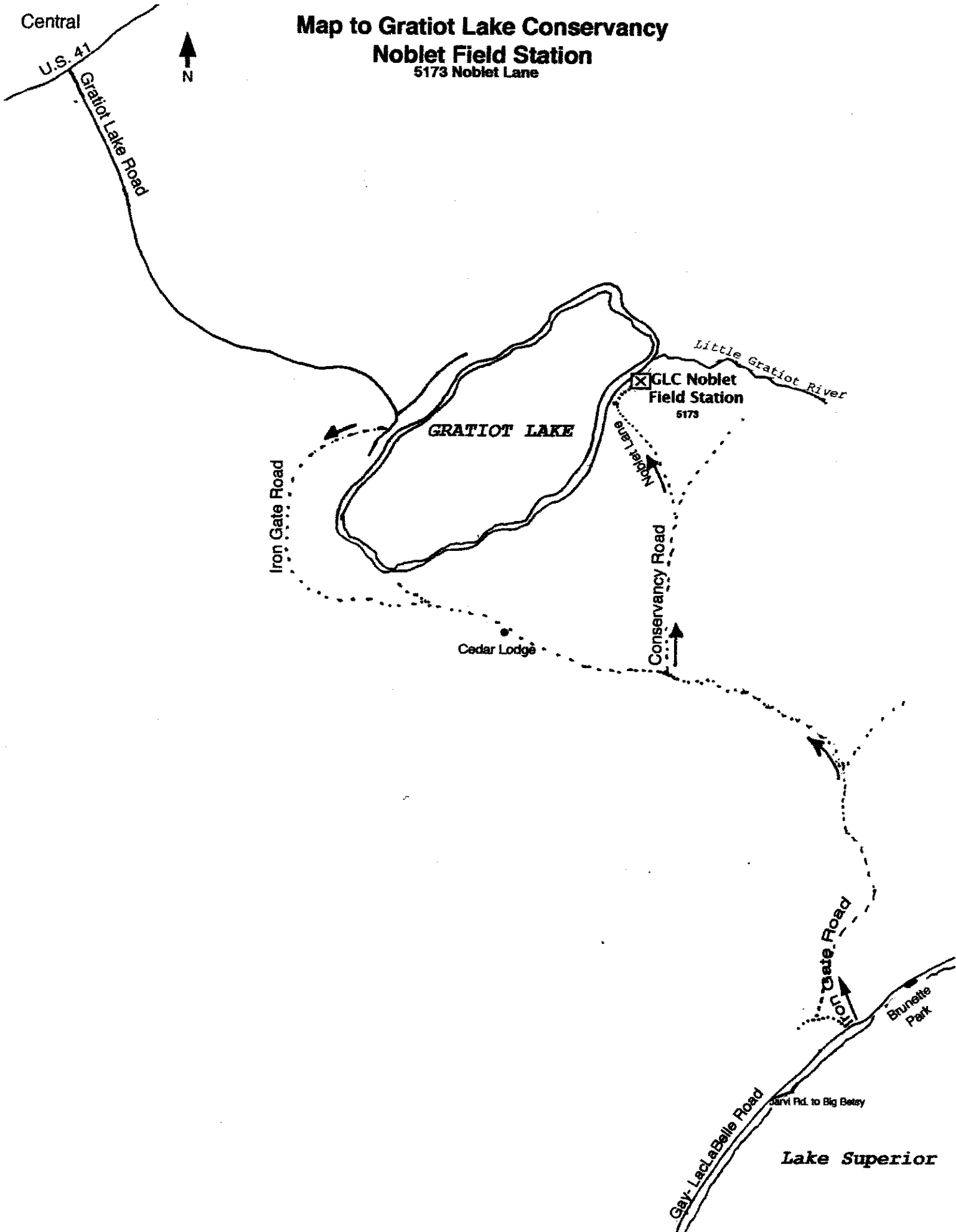

Lake Superior

GRATIOT LAKE CONSERVANCY

Gratiot Lake Preserve

SE corner of Gratiot Lake

By Land: NOTE that IRON GATE ROAD, CONSERVANCY ROAD, and NOBLET LANE are all dirt logging roads—high carriage cars, trucks, or four wheel drive vehicles are recommended. Logging may be occurring at any time off of Iron Gate Road or Conservancy Road so use caution. Roads may be impassable in wet or snowy weather.

From U.S. 41 Note that this NORTH ACCESS IS NOT RECOMMENDED due to very bad condition of Iron Gate Road on the North end as of 6/15/17.

At the town of Central **turn south onto the Gratiot Lake Road**. Follow the Gratiot Lake Road approximately 4.6 miles to Gratiot Lake.

When you reach the bottom of the hill after passing the mail boxes watch for Iron Gate Road, the first dirt road on the RIGHT. **Turn right on Iron Gate Road**. Take this old logging road around to the South side of the lake. Stay on the main dirt road, do not take any forks. At 3.3 miles you will pass Cedar Lodge camp. 1.5 miles past Cedar Lodge **turn left onto Conservancy Road**.

🌸 Follow Conservancy Road approximately 1.3 miles until you see Noblet Lane, a dirt road on the left.

Turn left onto Noblet Lane and go .8 mile to a clearing right before the gate to the Conservancy Preserve. Please park in this large, cleared area a few hundred feet before the Conservancy gate. If the gate is open you may park just inside of it, next to the trail head for **the Bear Paw Path**. To reach the Noblet Field Station and the path to the Little Gratiot River walk on the old road which runs northeast for 1/4 mile. Entrance to **the path to the Little Gratiot River** is beside the cabin and runs 1/4 mile.

From M-26, Gay-Lac Labelle Rd.:

Traveling South from Lac Labelle look for the Iron Gate Road on the right about .7 mile beyond Brunette Park. **Turn right on Iron Gate Road** .

▲ After about 2.1 miles on this road you will come to a prominent fork. Stay on the main road and bear left. Go another 1.3 miles until you come to Conservancy Road. **Turn right onto Conservancy Road** and follow directions at 🌸 above.

Traveling North from Gay approximately .7 mile past Big Betsy Road and past the point where the road crosses the Big Betsy River look for the Iron Gate Road on the left. (If you pass Brunette Park you have gone too far). **Turn left on Iron Gate Road** and follow directions in section marked with a ▲ immediately above.

By Kayak or Canoe: (NOTE: Gratiot Lake which has 1,438 acres of surface area and is nearly 80 feet deep in some areas. can be treacherous on very windy days.) Traveling on US 41 when you reach the town of Central turn South on to the Gratiot Lake Road. Follow the

Gratiot Lake Road approximately 4.6 miles to Gratiot Lake. At the bottom of the hill turn left on to Gratiot Lake Drive and proceed to Gratiot Lake's public boat launch.

The Conservancy Preserve is located on the south shore of the lake directly across from the boat launch. There is a seasonal dock at off of shoreline just southwest of the Noblet Field Station. It is usually in between mid-June and mid-September. The shallows extend quite a ways out, so you will probably have to lift your motor up to avoid damage. Lake bottom is sand and cobble with some bigger rocks here and there.

Beach your boat on the shoreline to either side of the rock pile and old iron structure (the deteriorated old dock) which is in front of the Noblet Field Station. Lots of big rocks near that old pier so use caution. Small watercraft can be beached at other points along GLC shoreline.

Information on the Bear Paw Path can be found in a box near the Noblet Field Station's back door. The path to the Little Gratiot River commences next to the Field Station. The Bear Paw Path commences about 1/4 of a mile SW of the Noblet Field Station off of Noblet Lane.